

## FDBS SERIES DOUBLE SHEAR BEAM STAINLESS STEEL

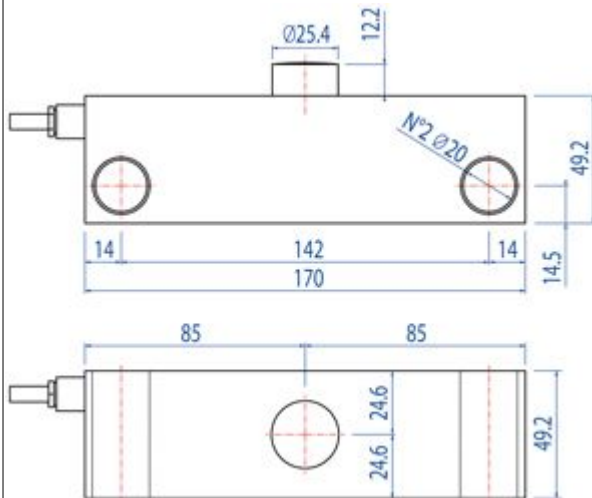

dimensions in mm

Wiring Code	
Colour	Function
GREEN	OUTPUT +
PURPLE	SENSE +
RED	INPUT +
WHITE	OUTPUT -
BLACK	INPUT -
GREY	SENSE -

Stainless steel double shear beam load cells suitable for building, for example, to make CE-M approved scales for high capacities or for weighing tanks and hoppers with the relevant accessories. High accuracy also with the expansion of the weighing structures.

CAPACITIES (kg): 10000, 20000, 30000.

OIML R60. C4 precision class.

17-4 PH stainless steel. IP68 protection.

### TECHNICAL FEATURES

C4 PRECISION CLASS

17-4 PH STAINLESS STEEL CONSTRUCTION

IP68 PROTECTION

MAX. CAPACITIES FROM 10000 TO 30000 kg

SHIELDED CONNECTION CABLE

TEST CERTIFICATE AVAILABLE UPON REQUEST

### MAIN FEATURES

Minimum load cell verification interval:  $V_{min} = E_{Max} / 10.000$

Combined error 0,03% of Full Scale Output (F.S.)

Full Scale Output: 2mV/V +/- 0,1%

Temperature effect on zero: 0,00116% /°C

Temperature effect on full scale output: 0,00097% /°C

Compensated Temperature Range: -10°C/+40°C

Operating Temperature Range: -30°C/+85°C



## FDBS LoadCell

	<p>Creep error after 30 minutes: &lt;0,02% F.S.          Maximum tolerated excitation voltage: 15 VDC          Input Resistance: 700 ± 7 Ohm          Output Resistance: 700 ± 7 Ohm          Zero Balance: +/- 1% F.S.          Insulation Resistance: &gt;5000 MOhm          Safe Overload: 150% F.S.          Ultimate Overload: 300% F.S.          6-wire shielded cable, 15m long</p>
	<b>ATEX VERSION</b>
	<p>The CCATEX certificate makes the load cell suitable for use in hazardous areas with protection methods according to: ATEX II 1G Ex ia IIC T6 (Ta -20÷+40°C) TX (Ta -20÷+65°C) Ga          ATEX II 1D Ex ta IIIC TX°C (Ta -20÷+40°C) TX°C (Ta -20÷+65°C) DaIP65.</p> <p>The certificate includes the manual and the ATEX CE conformity declaration (available in EN, DE, FR, and IT).  <b>IMPORTANT:</b> the certificate refers to the single load cell. For systems with more load cells, it is necessary to order one certificate for each load cell.</p>

### Available versions

Code	Max (kg)
FDBS-10T	10000
FDBS-20T	20000
FDBS-30T	30000

### Assembly kits

	Code	Description
	FDBSM	Stainless steel kit for assembling 1 FDBS cell up to 30000kg. (Load cell not included)



## FDBS LoadCell

---

---

**Fuertcell.Co.,ltd**

**[www.fuertcell.com](http://www.fuertcell.com)**

**[fuertcell@foxmail.com](mailto:fuertcell@foxmail.com)**