

## Dimension and Capacity

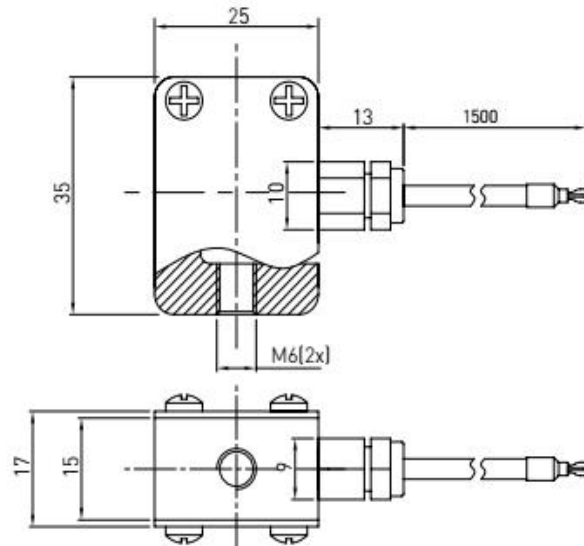

## Features & Applications

- Made of aluminium alloy or alloy steel
- Tension and compression application
- Customizable, IP65 protection
- Mainly used for pull and push dynamometer, hopper scale and industrial measuring systems

Capacity	Material	Weight
1/2/3/5/10/15/20/50kg	Aluminum alloy Alloy steel	0.1kg

## Specification

Rated Capacities	1,2,3,5,10,15,20,50(kg)
Rated Output	2.0 mV/V±10%
Zero Balance	±2% F.S.
Non-linearity	0.05%F.S.
Hysteresis	0.05%F.S.
Repeatability	0.05%F.S.
30mins Creep	0.05%F.S.
30mins Return	0.05%F.S.
Safe Overload	150 %F.S.
Ultimate Overload	200 %F.S.
Temperature Effect On Output	0.05 %F.S./ °C
Temperature Effect On Zero	0.05 %F.S./ °C
Input Impedance	410±30 Ω 385±5(Alloy steel)
Output Impedance	350±5 Ω
Insulation Impedance	≥5000 MΩ/(100VDC)
Recommended Excitation	10 VDC
Maximum Excitation	15 VDC
Operating Temperature Range	-20~80 °C
Construction	stainless steel
Protection Class	IP67
Cable	1.5/3 m
Mode of Connection	Red (EXC+),Black (EXC-),Green (SIG+),White (SIG-)