

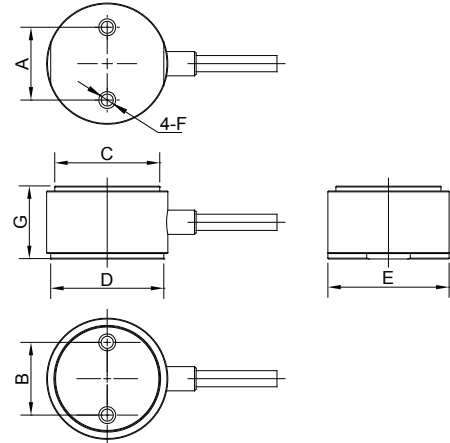

Dimensions



RATED CAPACITY	A	B	C	D	E	F	G
N/mm							
10~200	9	9	∅13	∅14	∅15	M2	9

Specification

Rated Output(mV/V)	2.0±0.2
Zero Balance	±2%FS
Non-linearity	±0.1%FS
Hysteresis	±0.1%FS
Repeatability	±0.1%FS
Creep(30min.)	±0.1%FS
Input Resistance	350±30 ohms
Output Resistance	350±5 ohms
Safe Overload	150%
Temperature	Compensated Range -10℃~+60℃
Temperature	Operating Range -20℃~+80℃
Insulation Resistance	≥5000M ohms
Excitation Voltage	5~10V DC(15V MAX)
Temp. Effect on Zero	≤0.005%FS/℃
Temp. Effect on Output	≤0.005%FS/℃
Materials	Stainless Steel
Cable Length	4m
IP Class	IP66
Cable Color Code	Red (EXC+) .Black (EXC-) .Green (SIG+) .White (SIG-)

Order Information

LOAD RATING	
FCT5-1kg	FCT5-2kg
FCT5-5kg	FCT5-10kg
FCT5-20kg	